

BICYCLE SAT NAV (G300N)

Item Check List

Please check all the following items have been included before starting.

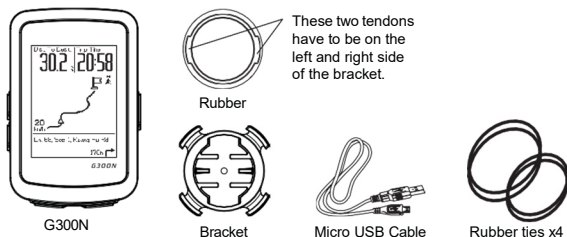

How to mount the bracket

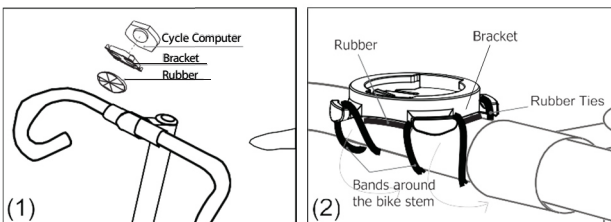

Use the rubber to tighten the bracket on the handlebar or stem with rubber ties.

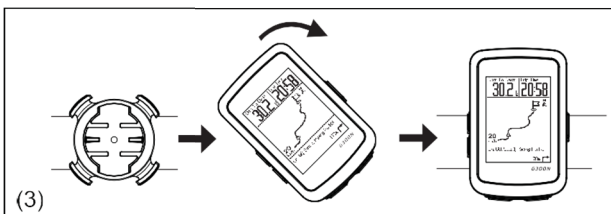

Place the GPS cycle computer on the bracket and secure it by turning clockwise.

DISPLAY AND KEY FUNCTIONS

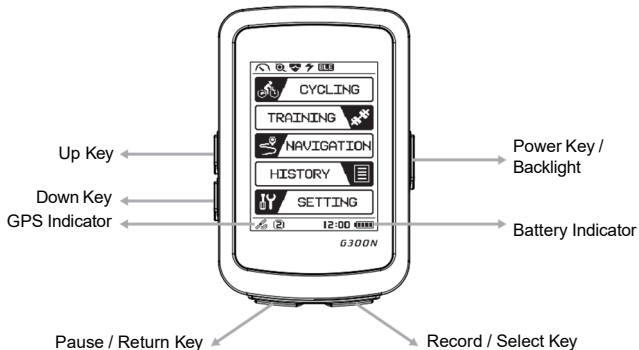

Turn on/off

To start the computer, hold the power key for 3 seconds until bee sound.

Auto Sleep

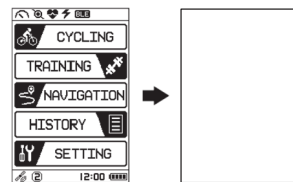

Auto sleep: When there is no recording after 6 minutes of no speed, and no button pressed the computer will turn off to save battery.

When there is recording after 1 hour with no speed, and no button pressed the computer will turn off to save battery.

Cycle

Press Up and Down Key to change mode.



NOTE: When the corresponding sensors are paired, the Cadence Mode, Heart Rate Mode, and Power Mode will appear.
The speed must maintain for 8 seconds or more to have ^{AVG} Cadence, ^{AVG} Heart Rate, ^{MAX} Heart Rate %, and ^{AVG} Power data.

Training

Training -> FTP Test -> My Workout

Navigation

Navigation -> View -> Delete

View: Select track press up/down key to switch and press OK to view.
Delete: Select track press up/down key to switch and press OK to delete.

History

History -> View -> Delete -> Delete All

Setting

Setting -> Profile -> Sensor -> Exercises -> General -> Altitude -> BLE Connect -> GPS System

Customized page

Setting -> Exercises -> User page -> Page -> Type

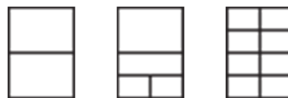

Press up/down key to select option.

Contrast

Setting -> General -> System -> Contrast

Set Altitude

Setting -> Altitude -> Location sync.

Backlight

Short press on power button to turn ON/OFF backlight.

Set Sensor

Setting -> Sensor -> Choose Sensor -> Scan

Set Clock

Setting -> General -> System -> Clock
Clock will automatically adjust when GPS signal has been received.

Set Unit

Setting -> General -> System -> Unit

Set User

Setting -> Profile -> User Profile

Record

Under cycle mode press record.

MAINTENANCE

If the display contrast changes and figures become faint, it's time to recharge the battery. Do not expose cycle computer to extremely cold or hot temperatures i.e. don't leave the unit in direct sunlight for extended periods of the time.

TROUBLESHOOTING

- Display is black or very light:**
The battery power may be low. Recharge the battery.
- Display becomes dark or black:**
The unit may be too hot. Place the unit in a shaded area, and it will return to normal.
- The unit operates slowly or struggled:**
The unit is too cold. Warm the unit, and it will return to normal.
- Data in display varies enormously:**
Check the surroundings for electromagnetic or away from the source of interference.
- Data in display shows slowly:**
The unit may be affected by low temperature factor but it does not influence the function reading when the temperature rises.
- Current Speed does not appear:**
It may cause by the following situation:
 - Speed from GPS: GPS signal is weak, please make sure turn on the GPS and move to the outdoor, a wide area without inter
 - Speed from the sensor: The distance & position is too far, please refer to the sensor's manual and adjust.
- Altitude seems not accurate:**
The device altitude can be entered for more accurate data.

WARRANTY

The statutory warranty provisions apply. Damage resulting from improper use, failure to observe the user manual and care instructions, environmental factors, normal wear and tear, or damage resulting from accidents, a fall/impact, or modifications to the product are excluded from the warranty. No new warranty period begins when the item is repaired or replaced.

IMPORTANT HEALTH NOTICE

- Please read over the following information before using the GPS computer.
- Never use the GPS computer in combination with other medical / implanted electronic equipment and device (especially heart pacemakers, EKG equipment, TENS equipment, cardio-pulmonary machines and pacemaker).
 - If you are severely ill or pregnant, please consult your doctor before using GPS computer.
 - Keep this device away from children.
 - As with most electronic receiving devices, there can sometimes be interference that causes inaccurate display readouts. Avoid using GPS computer near common sources of interference. These include high voltage power lines, air conditioning motor units, fluorescent lights, wristwatches, mobiles and computer.

Charging

- The suitable operating temperature is 0°C ~ 40°C.
- Please use Micro USB Cable to charge the battery for 3 hours for fully charge.
- BICYCLE SAT NAV support charging during operation.
- Do not overstretch the USB plug for keeping waterproof and dustproof.

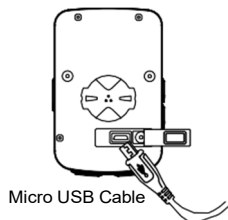

Micro USB Cable

Pair to Smart Phone

1. Download "Ride for Life" from Google play or APP Store.

Google play



App Store



2. Open the APP



3. Go into SETTING, then go to page that display BLE CONNECT, below ID will appear.



4. On the smart phone look for the same ID number which shows on the computer.

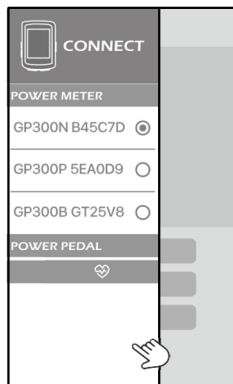

5. Press RECEIVE DATA, press the green RECEIVE DATA box again. Files will start receiving and a list of files which you had already record will be shown.

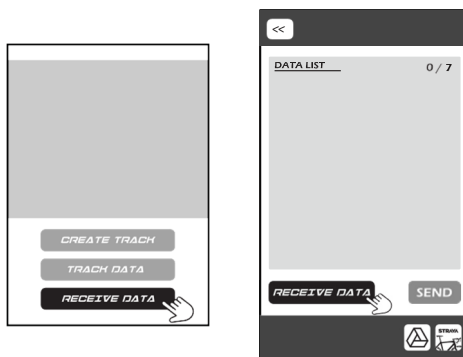

6. If you would like to upload the files to Strava, press the box of the file and press the Strava icon on the bottom right hand.

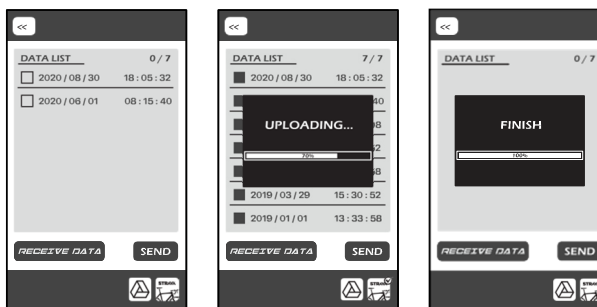

7. Log in to Strava first once all the steps are finish, there would be a little green check on the Strava icon, then press SEND. Upload will start and the data will be removed automatically after uploading.

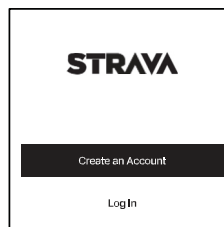

SPECIFICATIONS

	Computer
Operating Temperature	0°C~40°C
Storage Temperature	-10°C~50°C
Weight	65.2g
Size	89mm x 59.2mm x 20.4mm
Battery	Rechargeable Battery
Charging Time	3 Hours
Durability (without backlight)	20 Hours
Recording Time	80 Hours
Waterproof	IPX7
Transmission	Bluetooth/ANT+

Time	: 99 (hour): 59 (minute): 59 (Second)
Speed	: 0~99.9 KM / 0~62.4 Mile
Trip distance	: 0~9999.99 KM / 0~6249.99 Mile
Odometer	: 0~999999 KM/ 0~624999 Mile
Cadence	: 0~999 RPM
Heart Rate	: 30~240 BPM
Power	: 0~999 WATT
Current Gradient	: -99~99
AVG/MAX Gradient	: 0~99
ALT Gain/ Loss	: 0~30479 M / 0~99999 FT
Total Altitude	: 0~304799 M / 0~999999 FT
Maximum Altitude	: 0~3999 M / 0~9999 FT
Current Altitude	: -699~3999 M / -999~9999 FT

WHEEL SIZE CHART

Tire Scale	L(mm)	Tire Scale	L(mm)
14 x 1.50	1020	26 x 2.10	2068
14 x 1.75	1055	26 x 2.00	2055
16 x 1.50	1185	26 x 2.10	2068
16 x 1.75	1195	26 x 2.125	2070
18 x 1.50	1340	26 x 2.35	2083
18 x 1.75	1350	26 x 3.00	2170
20 x 1.75	1515	27 x 1	2145
20 x 1-3/8	1615	27 x 1-1/8	2155
22 x 1-3/8	1770	27 x 1-1/4	2161
22 x 1-1/2	1785	27 x 1-3/8	2169
24 x 1	1753	27.5 x 2.10	2170
24 x 3/4 Tubular	1785	27.5 x 2.30	2202
24 x 1-1/8	1795	29 x 2.10	2288
24 x 1-1/4	1905	29 x 2.30	2326
24 x 1.75	1890	650 x 35A	2090
24 x 2.00	1925	650 X 38A	2125
24 x 2.125	1965	650 X 38B	2105
26 x 7/8	1920	700 X 18C	2070
26 x 1(59)	1913	700 X 19C	2080
26 x 1(65)	1952	700 X 20C	2086
26 x 1.25	1953	700 X 23C	2096
26 x 1-1/8	1970	700 X 25C	2105
26 x 1-3/8	2068	700 X 28C	2136
26 x 1-1/2	2100	700 X 30C	2146
26 x 1.40	2005	700 X 32C	2155
26 x 1.50	2010	700C Tubular	2130
26 x 1.75	2023	700 X 35C	2168
26 x 1.95	2050	700 X 38C	2180
26 x 2.00	2055	700 X 40C	2200

DISPOSAL

Consumers are legally required to dispose of electrical and electronic devices separately from unsorted household waste at the end of their service life. This ensures environmentally friendly recycling and saves resources.

Batteries and battery packs which are not firmly encased in electrical or electronic devices and can be removed non-destructively must be removed from the device before it is delivered to a collection point and sent for proper disposal.

Some of the packaging material can be recycled. Dispose of the packaging in an environmentally friendly manner and put it in a recyclable material collection. Dispose of it at a public collection point.

